

AC Cloud Control gateway for Panasonic Etherea and domestic systems

Item number: INWFIPAN001I100

This gateway offers a cloud-based solution for remote control of Panasonic Etherea systems. AC Cloud Control is a mobile/web application for professional control of multibrand and multisite projects from one single dashboard, enhancing the user experience and optimizing the building's energy usage.



Control Panasonic units remotely from a powerful app - 1 indoor unit

Features and benefits

✓ Energy savings and efficiency, smart AC control

Use 365-day scheduling calendars, presence detectors, or window contacts to execute automated scenes, optimizing energy usage.

✓ Predictive Maintenance of the AC system

The AC Cloud Control gateway registers the AC unit's operating hours to schedule maintenance or filter cleaning according to the AC manufacturer specifications. This will extend the lifespan of the AC system.

✓ Scalable centralized control of the AC system

Control AC units from different brands and models across multiple locations from a single dashboard. Easily add or remove AC units as needed without infrastructure changes.

✓ Maximize the AC system supervision

The AC unit can be simultaneously controlled through a local remote controller and the AC Cloud Control system. Limit the operation mode and temperature settings to avoid improper use of the AC system.

✓ Remote diagnostics of the AC system

The gateway is connected directly to the AC unit communication bus, providing bidirectional communication, error codes, and descriptions to diagnose and troubleshoot issues remotely. As a result, on-site maintenance is minimized, leading to reduced operational costs.

✓ Multiuser control

Create multiple accounts assigning access rights according to each user profile. You decide who has the control and how much power they have.

✓ Avoid wiring efforts and reduce the installation complexity

This gateway drains the power of the AC unit, so no additional power supply is needed. It accesses the cloud using the Wi-Fi local network and is configured via Bluetooth.

✓ Connect, share data, and improve the AC system's operation

AC Cloud Control can be integrated with third-party systems like IFTTT, Google Assistant, Alexa, Siri Shortcuts, or a professional REST API.

AC Cloud Control gateway for Panasonic Etherea and domestic systems



General	
Net Width (mm)	70
Net Height (mm)	100
Net Depth (mm)	28
Net Weight (g)	20
Packed Width (mm)	133
Packed Height (mm)	135
Packed Depth (mm)	35
Packed Weight (g)	120
Operating Temperature °C Min	0
Operating Temperature °C Max	60
Input Voltage (V)	From the AC unit.
Power Connector	Other
Capacity	1 indoor unit.
Installation Conditions	Install this gateway inside the indoor unit or inside a connection box to protect it from electrostatic discharge.
Content of Delivery	Intesis Gateway, Installation Manual, AC Connection cable.
Mounting	Wall mount
Housing Materials	Plastic
Warranty (years)	3 years
Packaging Material	Cardboard

AC Cloud Control gateway for Panasonic Etherea and domestic systems



Identification and Status

Product ID	INWFIPAN001I100
Country of Origin	Sweden
HS Code	8517620000
Dual Usage	No
Export Control Classification Number (ECCN)	EAR99

Physical Features

Contains Battery	No
------------------	----

Certifications and Standards

ETIM Classification	EC001604
CE	Yes
CB	Yes
UL	Yes
WEEE Category	IT and telecommunications equipment

AC Cloud Control gateway for Panasonic Etherea and domestic systems



Use Case

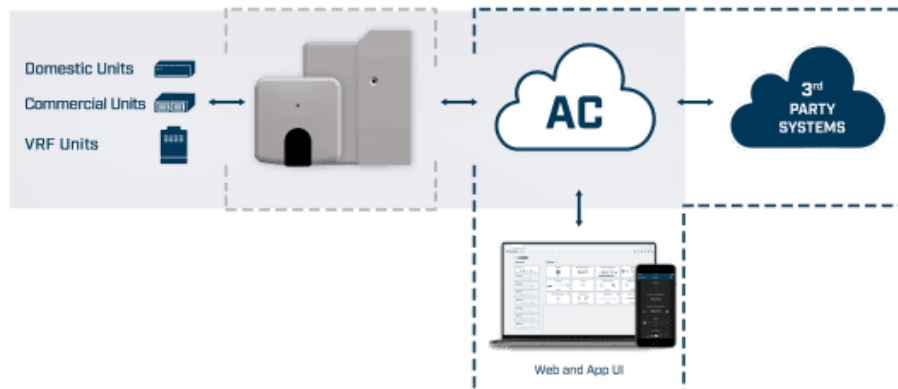

Network topology.

Panasonic

AC Cloud Control



Integration example.