

AC Cloud Control gateway for Panasonic ECOi and PACi systems

Item number: INWFIPAN001R100

This gateway offers a cloud-based solution for remote control of Panasonic ECOi and PACi systems. AC Cloud Control is a mobile/web application for professional control of multibrand and multisite projects from one single dashboard, enhancing the user experience and optimizing the building's energy usage.



Control Panasonic units remotely from a powerful app - 1 indoor unit

Features and benefits

- ✓ **Energy savings and efficiency, smart AC control**
Use 365-day scheduling calendars, presence detectors, or window contacts to execute automated scenes, optimizing energy usage.
- ✓ **Predictive Maintenance of the AC system**
The AC Cloud Control gateway registers the AC unit's operating hours to schedule maintenance or filter cleaning according to the AC manufacturer specifications. This will extend the lifespan of the AC system.
- ✓ **Scalable centralized control of the AC system**
Control AC units from different brands and models across multiple locations from a single dashboard. Easily add or remove AC units as needed without infrastructure changes.
- ✓ **Maximize the AC system supervision**
The AC unit can be simultaneously controlled through a local remote controller and the AC Cloud Control system. Limit the operation mode and temperature settings to avoid improper use of the AC system.
- ✓ **Remote diagnostics of the AC system**
The gateway is connected directly to the AC unit communication bus, providing bidirectional communication, error codes, and descriptions to diagnose and troubleshoot issues remotely. As a result, on-site maintenance is minimized, leading to reduced operational costs.
- ✓ **Multiuser control**
Create multiple accounts assigning access rights according to each user profile. You decide who has the control and how much power they have.
- ✓ **Avoid wiring efforts and reduce the installation complexity**
This gateway drains the power of the AC unit, so no additional power supply is needed. It accesses the cloud using the Wi-Fi local network and is configured via Bluetooth.
- ✓ **Connect, share data, and improve the AC system's operation**
AC Cloud Control can be integrated with third-party systems like IFTTT, Google Assistant, Alexa, Siri Shortcuts, or a professional REST API.

AC Cloud Control gateway for Panasonic ECOi and PACi systems



| General | |
|------------------------------|--|
| Net Width (mm) | 70 |
| Net Height (mm) | 100 |
| Net Depth (mm) | 28 |
| Net Weight (g) | 101 |
| Packed Width (mm) | 133 |
| Packed Height (mm) | 135 |
| Packed Depth (mm) | 35 |
| Packed Weight (g) | 195 |
| Operating Temperature °C Min | 0 |
| Operating Temperature °C Max | 60 |
| Input Voltage (V) | From the AC unit. |
| Power Connector | Other |
| Capacity | 1 indoor unit. |
| Installation Conditions | Install this gateway inside the indoor unit or inside a connection box to protect it from electrostatic discharge. |
| Content of Delivery | Intesis Gateway, Installation Manual. |
| Mounting | Wall mount |
| Housing Materials | Plastic |
| Warranty (years) | 3 years |
| Packaging Material | Cardboard |

AC Cloud Control gateway for Panasonic ECOi and PACi systems



Identification and Status

| | |
|--|------------------------|
| Product ID | INWFIPAN001R100 |
| Country of Origin | Spain |
| HS Code | 8517620000 |
| Export Control Classification Number (ECCN) | EAR99 |
| Supply Risk Factor ERP | Volume not defined yet |

Certifications and Standards

| | |
|----------------------------|-------------------------------------|
| ETIM Classification | EC001604 |
| WEEE Category | IT and telecommunications equipment |



Use Case

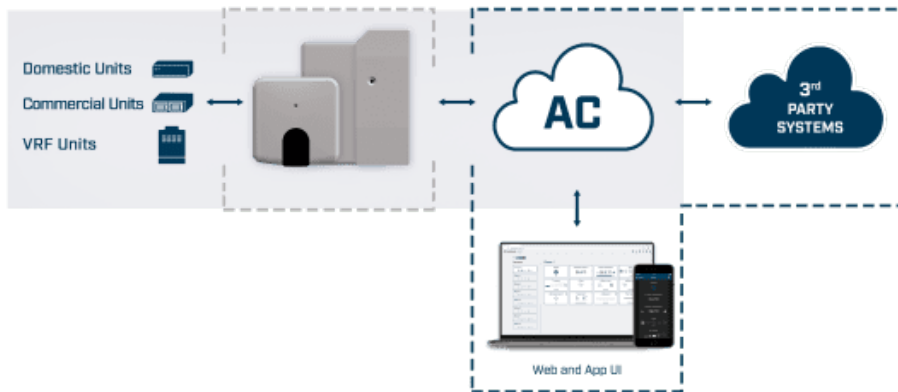

Network topology.

Panasonic

AC Cloud Control



Integration example.